

AUGUST IN THE GARDEN

Spring is just around the corner, but there is still time to put in some groundwork to prepare for your garden's best season yet. Survey your garden and treat any plants that have become sick or damaged over winter, and ensure you're stocked up with the right products for a spring feed.

AUGUST BIRTH FLOWERS



GLADIOLUS

Gladiolus is a genus of perennial cormous flowering plant in the iris family and is amongst the most wonderful corms available for the summer garden. There are an assortment of bold colours available from late winter onwards including red, pink, orange, yellow, and white.

When planting, place your corms approximately 10 to 15cm deep, depending on its size, and space approximately 15cm apart. Once they are flowering, fertilise fortnightly with **Sudden Impact for Roses** Advanced Biological Formula.



BROWN BORONIA

Native to the south-west of Western Australia, Boronia is a spring flowering shrub that produces flowers with rich plum-coloured petals and yellow centres, and provides a beautiful aroma perfectly fit for the new season.

Enjoy plenty of springtime blooms by planting in an area with dappled shade and moist, well-drained soil. Feed regularly with **Bush Tucker** to supply essential nutrients and allow your boronia

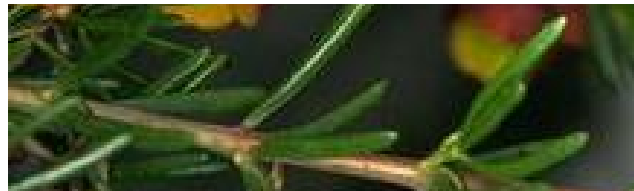

to thrive. A fortnightly application of **GOGO Juice** is also recommended, and mulch with **Whoflungdung** to keep the soil moist.

AUGUST FERTILISING GUIDE



Year round fertilising for year round health

Like humans and animals, plants require regular feeding throughout the year – at least once in each season.

Happy, healthy, well nourished plants are more resistant to pests, diseases, heat stress and frost.

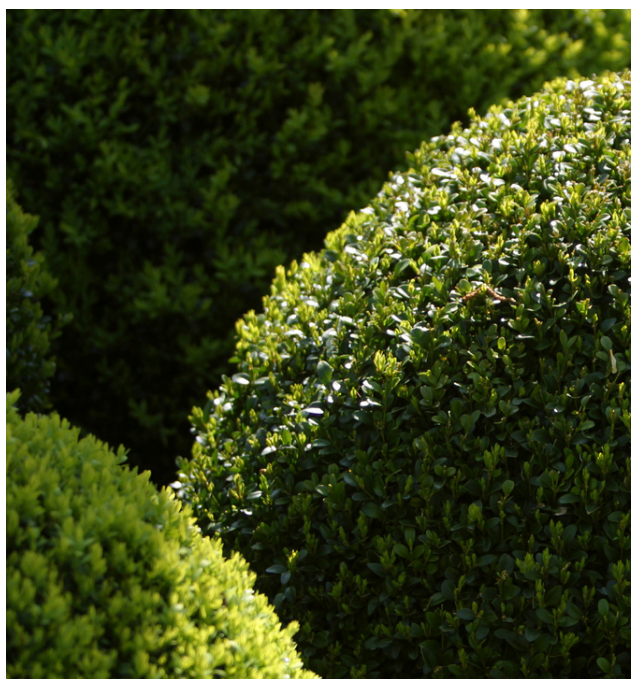

HEDGES

If you have hedges around your garden, they will soon be ready for a feed with **Sudden Impact for Lawns + POPUL8**. The combination of balanced nutrition from Sudden Impact for Lawns with the diverse microbiology from POPUL8 will set up your plants for optimum growth over the months ahead.

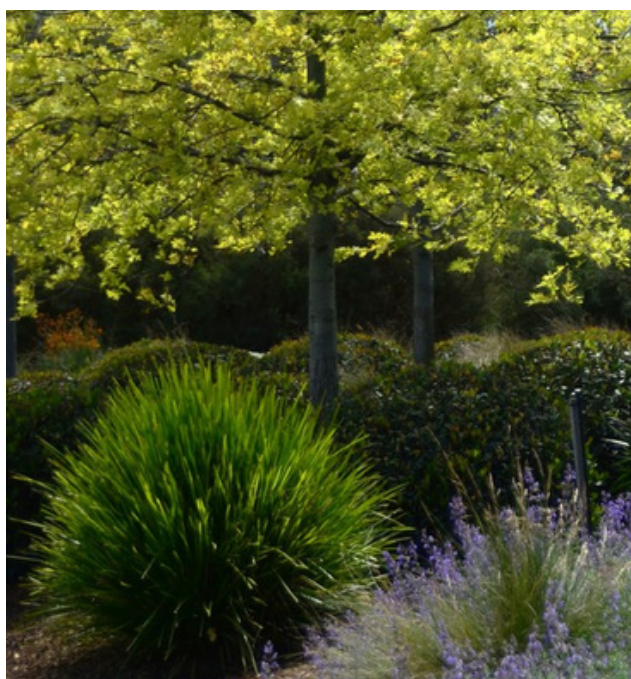

REJUVENATE WITH POPUL8

Have a wander around the garden and note any plants that are looking sick or stressed. These plants will benefit from an application of **POPUL8** as soon as the weather warms up to improve their condition.





PLANNING PLANTING

Now is the ideal time to plan what vegetables and flowers you'd like to plant this spring. You could even begin sowing tomato seeds if you have a glasshouse or protected position in which to raise them. Once germinated a light application of **Human Beans** which has been watered in with GOGO Juice will provide them with their first feeding requirements.



PERENNIALS

Visit your garden centre to check out what early perennials have arrived in store. This will help you with planning your spring and summer colour. A great one to watch for are the huge range of salvias.

When you take home these beauties, we recommend adding **Rapid Raiser** throughout the soil as your planting. Water in with **GOGO Juice**.



ACID LOVING PLANTS

Acid loving plants such as camellias, azaleas and daphne are in flower now.

Apply **Kahoona** every eight weeks to keep them strong over the next few months, and to allow early spring flowering varieties to develop a strong set of flower buds.





NATIVES

Fertilise your natives now with **Bush Tucker** Advanced Biological Formula or pellets to encourage strong spring growth. Bush Tucker includes potassium, which is essential for forming a strong bond between the flower and the stem and allowing the flowers to last longer.



ROSES

Roses often don't like being planted where another rose has previously grown. If you're removing old, damaged, or diseased roses and want to replant in the same area, add a generous quantity of fresh soil to where the rose was planted – about a wheelbarrow full. Add **Seamungus** throughout the soil and water in with **POPUL8** to assist the new rose to settle back into this position.



POTTED PLANT FERTILISING GUIDE

All potted plants will benefit from year round fertilising to keep them thriving throughout each season. Application rates differ depending on the size of the pot you are using, so to make it easier for you, Neutrog have put together the basic guide below.



Pot Size	40"/100cm	30"/76cm	20"/50cm	12"/30cm	6"/15cm
Strike Back for Orchids:	100g	75g	50g	30g	15g
Sudden Impact for Roses:	185g	135g	85g	45g	15g
Kahoonia:	185g	135g	85g	45g	15g
Seamungus:	250g	190g	125g	75g	40g
Bush Tucker:	150g	115g	75g	45g	25g
Cyganic:	185g	135g	85g	45g	15g
Human Beans:	250g	190g	125g	75g	40g

AUGUST PLANTING GUIDE

Whether your adding new plants to the garden, reviving the soil after removing sick plants or simply preparing your garden for the season ahead, all gardens will benefit from our 'trifecta' of GOGO Juice, Seamungus and Whoflungdung to ensure a biologically active base for plants to thrive in.

With plenty of great fruits, vegetables, herbs and flowers to plant now, a boost of microbiology will reward gardeners with plants that are resilient to stress, pests and diseases.

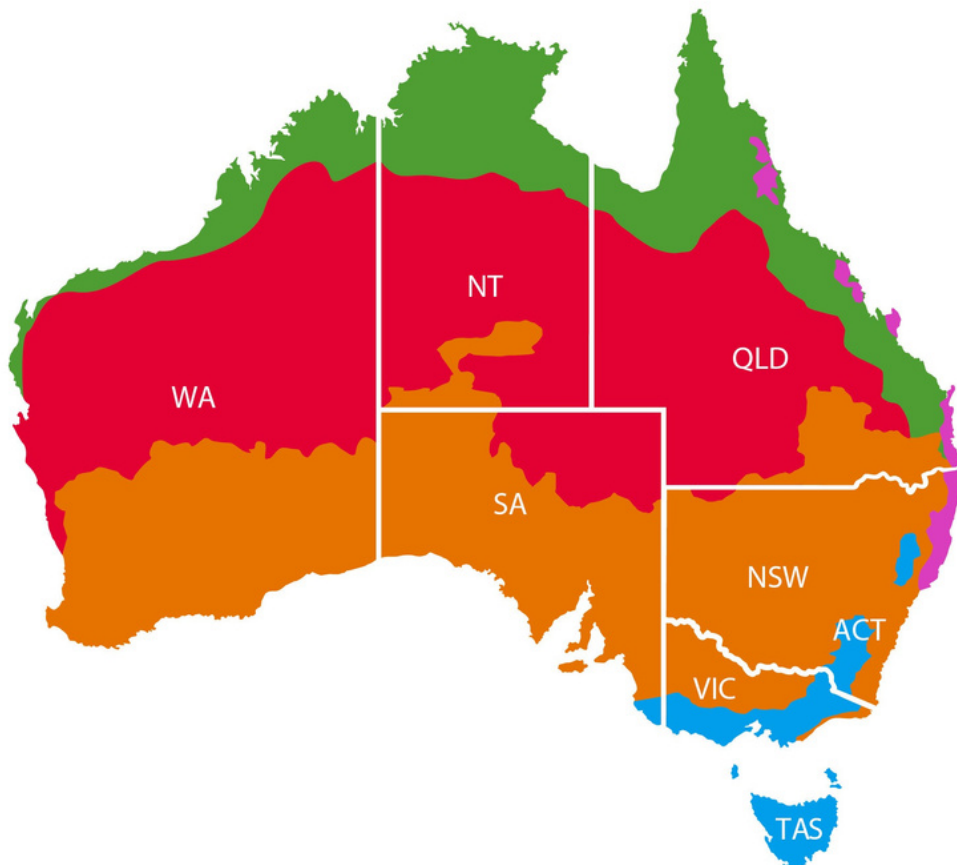

COOL ZONE: Melbourne, Tasmania and Cool Highlands**FRUIT & VEGETABLES**

Asparagus	Radish
Beetroot	Snow Peas
Broad Bean	Shallot
Broccoli	Silver beet
Cabbage	Spinach
Carrot	Spring Onion
Cauliflower	
Celery	
Leek	
Onion	
Peas	

HERBS

Chives
Dill
Garlic
Mint
Oregano
Parsley
Thyme

FLOWERS

Alyssum	Pansy
Aquilegia	Phlox
Begonia	Polyanthus
Cornflower	Poppy
Delphinium	Primula
Dianthus	Snapdragon
Forget me Not	Stock
Foxglove	Verbena
English daisy	Viola
Lobelia	
Lupin	

WARM ZONE: Sydney, Perth, Adelaide and Inland NSW/VIC**FRUIT & VEGETABLES**

Asparagus	Rhubarb
Beetroot	Silver Beet
Broad Beans	Spinach
Cabbage	
Carrot	
Cauliflower	
Celery	
Peas	

HERBS

Chives
Cress
Dill
Garlic
Marjoram
Oregano
Parsley

FLOWERS

Alyssum	Hollyhock
Candytuft	Larkspur
Canterbury Bells	Pansy
Clarkia	Phlox
Cineraria	Poppy
Daphne	Primula
Delphinium	Snapdragon
Forget-me-not	Sweet Pea

HOT ZONE: Arid or Outback Areas including Geraldton, Warburton and Mt Isa**FRUIT & VEGETABLES**

Asparagus	Shallot
Broad Beans	Spinach
Cabbage	
Carrot	
Cauliflower	
Leek	
Lettuce	
Onion	
Rhubarb	
Silver Beet	
Spinach	

HERBS

Chives
Fennel
Garlic
Oregano
Parsley
Sage
Rosemary
Thyme

FLOWERS

Ageratum	Nasturtium
Aster	Petunia
Balsam	Portulaca
Carnation	Rudbeckia
Chrysanthemum	Salvia
Cockscomb	Snapdragon
Coleus	Sunflower
Cosmos	Torenia
Dahlia	Verbena
Gaillardia	Wallflower
Gerbera	Zinnia
Impatiens	
Marigold	

TROPICAL ZONE: Broome, Darwin and Townsville**FRUIT & VEGETABLES**

Avocado	Lettuce
---------	---------

HERBS

Coriander

FLOWERS

Ageratum	Geranium
----------	----------

Beans	Okra	Dill	Aster	Gerbera
Bok Choi	Onion	Garlic	Balsam	Impatiens
Broccoli	Passionfruit	Marjoram	Calla Lillies	Marigold
Cabbage	Pawpaw	Mint	Canna	Nasturtium
Capsicum	Peas	Oregano	Carnation	Portulaca
Carrot	Potato	Parsley	Celosia	Snapdragon
Cauliflower	Pumpkin	Rocket	Cockscomb	Sunflower
Citrus	Silver beet	Sage	Coleus	Torenia
Cucumber	Strawberries	Thyme	Dahlia	Verbena
Eggplant	Sweet Corn		Dianthus	Wallflower
Kale	Tomato		Gaillardia	Zinnia

SUB-TROPICAL ZONE: Byron Bay, Brisbane and Rockhampton

FRUIT & VEGETABLES

Avocado
Beans
Beetroot
Cabbage
Citrus
Kale
Leek
Lettuce
Onion
Passionfruit
Pawpaw
Radish
Silver Beet
Tomato

HERBS

Comfrey
Cress
Dill
Garlic
Lemon Balm
Marjoram
Mint
Oregano
Parsley
Rocket
Rosemary
Sage
Thyme

FLOWERS

Ageratum
Alyssum
Aster
Begonia
Candytuft
Carnation
Cineraria
Cockscomb
Cornflower
Delphinium
Dianthus
Gaillardia
Impatiens
Linaria
Marigold
Poppy
Primula
Salvia
Snapdragon
Sunflower
Sweet Pea
Verbena
Viola

KEEP IN TOUCH

Stay in the loop with all things Neutrog by following our Facebook and Instagram pages. We are always posting seasonal gardening and fertilising tips along with plenty of information about Neutrog products and R&D projects.

You can also learn more about the products mentioned in this guide by visiting our website.